

MODEL **ZB003340**

1/2" Stopvalve concealed part, opening counterclockwise

AVAILABLE FINISHINGS



04 04 Without finishing

CHARACTERISTICS

Installation **Concealed**

Concealed **1**

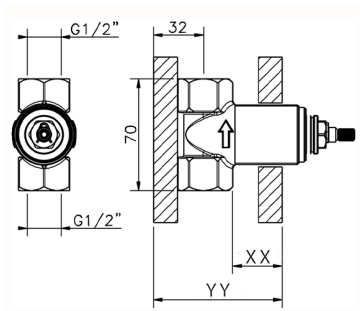
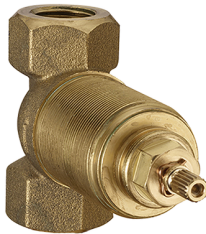

Piastra/Plate/Plaque/Platte/Placa
 2-3mm: XX 31-46 YY 80-95
 10mm: XX 25-40 YY 76-91



2026-04-06